

10" Anti-Entrapment Suction Outlet Cover and Double/Deep Frame

VGB Series

Product Specification Sheet

The AquaStar line of suction outlet covers, compliant with the new Virginia Graeme-Baker Pool and Spa Safety Act (ASME/ANSI A112.19.8a-2008)

Features

For single or multiple drain use (see installation instructions)

Single

Floor: 206 GPM at 5.8 fps
Wall: 96 GPM at 2.8 fps

Dual

Floor: 206 GPM at 2.9 fps
Wall: 96 GPM at 1.4 fps

Triple system

Floor: 412 GPM at 3.9 fps
Wall: 288 GPM at 2.7 fps
Floor/wall: 157 GPM at 1.5 fps

11.2 square inch opening

#316 stainless steel screws

Manufactured from superior UV-resistant engineered polymers

Meets or exceeds NSF 50/ASME/ANSI A112.19.8a-2008 national standards and ASTM G154 UV testing

Listed with IAPMO R&T

4" deep mud frame keeps field-fabricated sump at required safe depth

Sub-frame allows for secondary safety drain attachment (optional)

4 per case



Model # 10AVDDxxx

Part Numbers / Colors

- 10AVDD101 White
- 10AVDD102 Black
- 10AVDD103 Lt. Gray
- 10AVDD104 Blue
- 10AVDD105 Dk. Gray
- 10AVDD106 Bone
- 10AVDD107 Taupe
- 10AVDD108 Tan

**VGB 2008
Compliant**

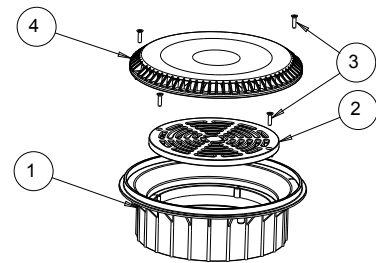
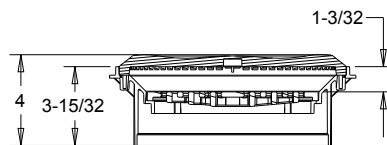
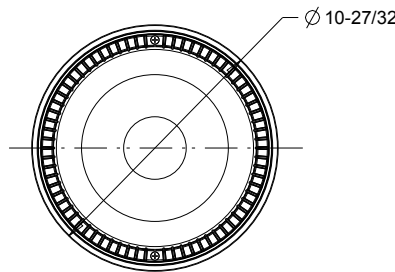

1. 10" anti-entrapment round deep frame
2. 8" flat grate (optional after 12/08)
3. #10 flat head phillips screw, qty 4
4. 10" anti-entrapment cover